

PTE Series D56mm Modular Style LED Tower Light



PTE series tower Lights combine the latest LED technology with UL safety technology.

With a new concept and innovative design, PTE series light towers are ideal for factory automation and many applications.

- Stylish design
- LED modular components
- Bright & even light distribution through prism-cut lenses
- Fast & easy assembly with inter-locking construction
- Five different mounting styles
- Optional 85dB Buzzer (fixed or adjustable volume)
- IP65 rated
- RoHS compliant



Ordering Information

PTE - A P F - 3 02 - RYG - B (H) W

※ Options

① ② ③ ④ ⑤ ⑥ ⑦ ⑧ ⑨

1. Body Unit

S	Flat Based Body	Code 7 + Code 18
A	Pole Mount Standard Body	Code 7 + Code 10
D	Short Body	Code 6
T	Terminal Body	Code 15
L	Small Surface Body	Code 17 + Code 18

Note: "D", "L" Type - Power Supply 24V AC/DC Only

2. Mounting Style

C	Surface Mount	Code 18
G	Mount Base (MAM-B070B)	Code 8 + Code 16
P	Pole + Mount Base (MAM-B070D)	Code 8 + Code 11
R	Pole + Mount Base (MAM-B070R)	Code 8 + Code 20
M	Pole + Mount Base (MAM-B025)	Code 8 + Code 9
W	Pole + Wall Mount Bracket (MAP-DS40)	Code 8 + Code 12
J	Pole Adjustable Type	Code 21 + Code 11

Note: R Type Mount base - 180-degree revolution

3. Light Style

	Steady Light
F	Steady + Flashing Light
B	Steady + Buzzer (Fixed Sound)
V	Steady + Buzzer (Adjustable Sound)
Z	Steady + Flashing + Buzzer (Fixed Sound)
X	Steady + Flashing + Buzzer (Adjustable Sound)

4. Number of Stacks

1	1 Light
2	2 Lights
3	3 Lights
4	4 Lights
5	5 Lights

Note: Buzzer type - up to 4 tiers

5. Power Supply

02	24V AC/DC
FF	90-240V AC

6. Lens Colors (Top to Bottom)

R	Red
Y	Yellow
G	Green
B	Blue
C	Clear

Options

7. Body Colors

B	Black
----------	-------

Note: Standard Body Color - White Ivory.

8. Option

(V)	Continuous Flashing Flashing Cycle: (3~4 Times/Second)
(C)	Buzzer Continuous sound (Sound: Pi-----)
(H)	Buzzer 100db type - Adjustable Sound - Model: MPZ-56H

9. Lens Colors

W	All Lens Colors - Clear
----------	-------------------------

Exploded View / Part Code

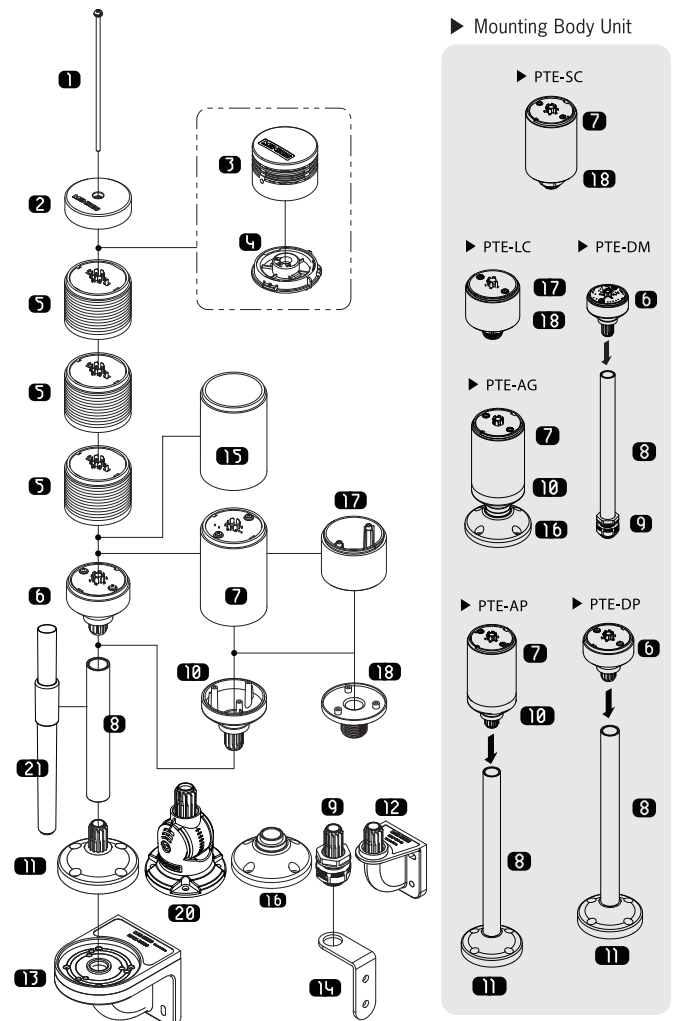

See Page 34 ~ 36
for Mounting Options and Accessories.



Specifications

Body Units

Operation/Function	Steady, Flashing, Buzzer
Power Supply	AC/DC 24V, AC 90 ~ 240V 50/60Hz
Lens Color	Red, Yellow, Green, Blue & Clear
Maximum Tier	5
Flash Rate	80 times/minute, 3~4 times/Second (options - V type)
Vibration	0.75mm at 10~55Hz
Ambient Temperature	-15°C~40°C
Storage Temperature	-40°C ~ 70°C
Ambient Humidity	45~85% RH
Degree of Protection	IP65 / IP50 (with Buzzer)
Approvals	CE, UL, RoHS
Recommended Wire Size	1007 UL / 22AWG

LED Modules

LED Color	Red / Yellow	Green / Blue / Clear
Current/Power (DC24V)	27mA / 0.65W	35mA / 0.84W
Weight	App. 2.8g	

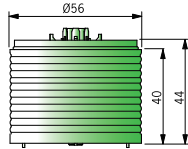

Buzzer Kits

Type	Standard Buzzer Sound - pi pi pi pi		
Model	MPZ-56F	MPZ-56G	MPZ-56H
Level Style	Fixed Sound	Adjustable Sound Level	Adjustable Sound Level
Sound Level	85dB/300mm	10~85dB/300mm	10~100dB/1M
Current / Power	30mA / 0.72W	30mA / 0.72W	150mA / 3.6W

Dimensions <Unit: mm>

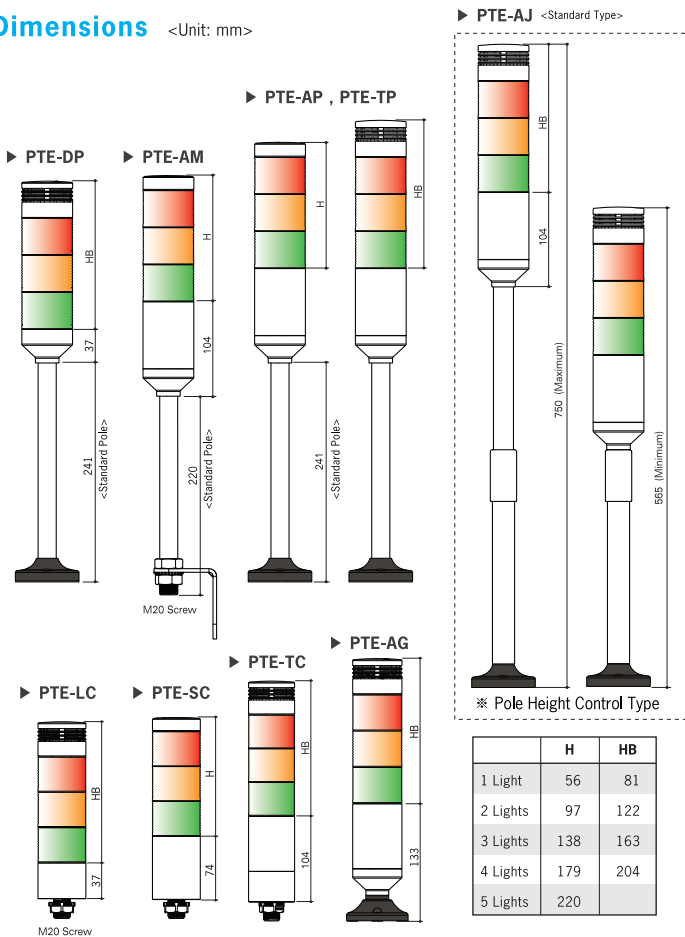

* The above specifications are changeable at anytime without notice.

Wiring Diagram

24V AC/DC Steady Lights (with Buzzer)

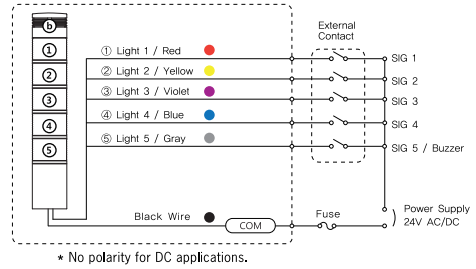

90 ~ 240V AC Steady Lights (with Buzzer)

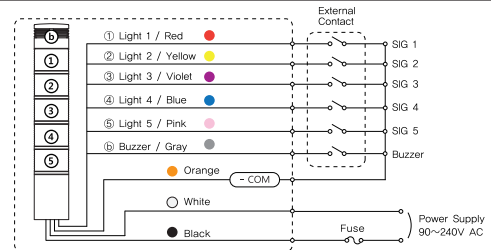

24VAC/DC, 90~240V AC Steady or Flashing Lights (with Buzzer)

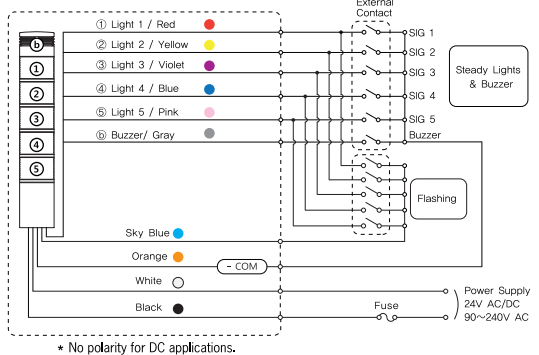

Terminal Type Connections

Pin #	Description
1	Light 1
2	Light 2
3	Light 3
4	Light 4
5	Light 5 or Buzzer
6	Steady COM
7	Flashing COM
A	Power Supply (-)
B	Power Supply (+)

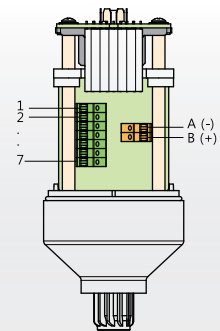

Recommended Wire Size
 UL 1007 AWG 22~16
 UL 1430 AWG 22~16
 * Use 75°C CU Wire only.

Buzzer Kits Dimensions

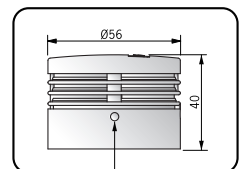

Sound Level Adjuster
 Model: MPZ-56G, MPZ-56H