

Gryphon-HC Handheld Products Cleaning Procedure Applicable to Gryphon I GD4XXX-HC, GM4XXX-HC, GBT4XXX-HC Healthcare Models



Corded Models

Exterior surfaces and scan windows exposed to spills, smudges or debris accumulation require periodic cleaning to ensure best performance during scanning operations.

Use a soft, lint-free cloth or lens tissue to clean the product. Dampen it with an approved cleaning agent. Gently wipe all surfaces.

Use approved cleaning agents only (see Table 1 below).

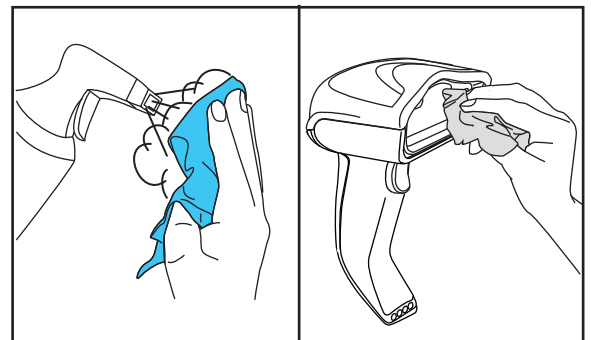

CAUTION

Do not use abrasive or aggressive cleansing agents or abrasive pads to clean scan windows, contacts, or plastics.

Do not spray or pour liquids directly onto the unit.

Table 1. Tested Cleaning Agents

Item	Description	Item	Description
Sani-Cloth® HB, Sani-Cloth® Plus, Super SaniCloth®	Quaternary Ammonium Chloride solution	Virex® 256	n-Alkyl Dimethyl Benzyl Ammonium Chloride; Didecyl Dimethyl Ammonium Chloride
Hepacide Quat II	Virucidal disinfectant cleaner	409® Glass and Surface Cleaner	Isopropanol (Isopropyl Alcohol), 2 propanol, dimetil carbinol
Alcohol Wipes	70% Isopropyl Alcohol	Windex® Blue	Isopropyl Alcohol
CaviWipes™	Isopropanol 10-20%; Ethylene Glycol Monobutyl Ether 1-5%	Clorox® Bleach	Sodium Hypochlorite; Sodium Hydroxide
100% Gentle dish soap and water			

*When using Ammonia Chloride Solutions be sure to remove residue from the contacts after cleaning.

Cordless Models

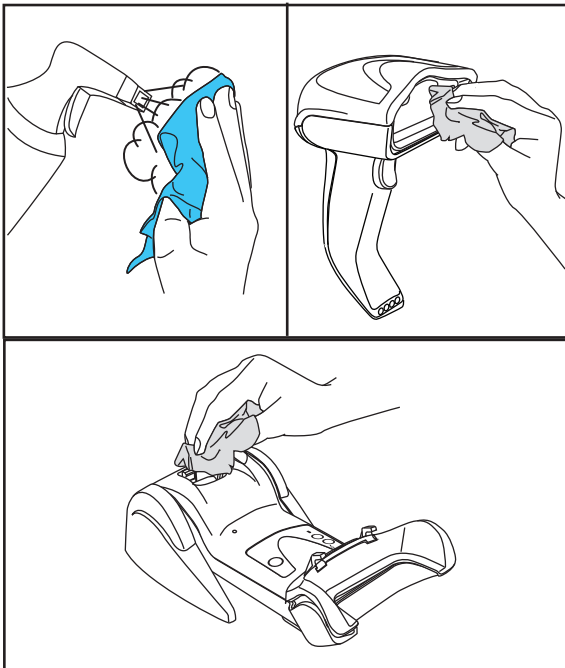

Exterior surfaces and scan windows exposed to spills, smudges or debris accumulation require periodic cleaning to ensure best performance during scanning operations. Contacts on the scanner and the base should also be cleaned as needed to ensure a good connection. See below for specific information on how to clean the metal contacts.

Use a soft, lint-free cloth or lens tissue to clean the product. Dampen it with an approved cleaning agent. Gently wipe all surfaces. A cotton swab may be used only on hard-to-reach handheld contacts.

Use approved cleaning agents only (see Table 1).



CAUTION

Do not use abrasive or aggressive cleansing agents or abrasive pads to clean scan windows, contacts, or plastics.

Do not spray or pour liquids directly onto the unit.

Handheld Contacts

1. Moisten a soft dry cloth with an approved cleaning agent (see Table 1).
2. Rub the cloth back and forth across the contacts. Use care not to leave any cloth residue.
3. Use the cloth to remove any dirt near the contacts area.
4. Repeat steps 1-3 using a clean dry cloth.
5. Finish by using another clean dry cloth to remove any residue of the cleaning agent from the contacts.



Cradle Contacts



1. Remove the power cable before cleaning the contacts.
2. Moisten a soft dry cloth with an approved cleaning agent (see Table 1).
3. Rub the cloth from one side of the contacts to the other, moving it slowly back and forth. Use care not to leave any cloth residue.
4. Use the cloth to remove any dirt near the contacts area.
5. Repeat steps 2, 3 and 4 using a clean dry cloth.
6. Finish by using another clean dry cloth to remove any residue of the cleaning agent from the contacts.

