

MS86W Series Low-head Multi-function indicator Light D86mm LED Steady/Flashing/Rotating Lights



The MS86W series is an LED beacon featuring three selectable light patterns of Flashing or rotation for diversified uses. The clear lens makes it easier to see the light, even in bright ambient conditions.



Product Features

- Flashing, Rotation, Continuous
- Enhanced Illumination: Use of long-life, super bright LED.
- Energy Efficient: Low power consumption.
- Main Body: heat resistant ABS resin.
- Cap Lens: impact and heat resistant polycarbonate resin.
- Installation: Indoor
- Available Colors: Red, Yellow, Green, Blue, Clear

Max 80dB at 1m (24V DC Only)

Ordering Information

MS86W - R 0 0 - R
 ① ② ③

1. Light Style

R	LED Steady + Flashing + Rotating
B	LED Steady + Flashing + Rotating + Buzzer <Buzzer function - DC 24V Only>

2. Power Supply

00	12~24V DC
02	24V DC

3. Lens Colors

R	Red	B	Blue
Y	Yellow	C	Clear
G	Green		

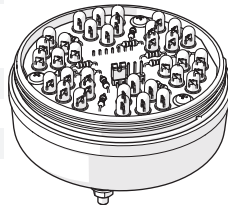

■ Steady light



■ Flashing light

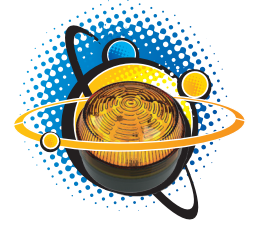

■ Rotating light

Functional Specifications

LED Color Code		R (red), Y (yellow), G (green), B (blue), C (Clear)		
Current	Illumination Color	Red / Yellow	Green / Blue / Clear	Buzzer
	DC 12V	280mA	260mA	30mA
DC 24V	200mA	180mA		
Flashing Cycle		Approx. 80 ±10 flashes per minute		
Continuous Flashing		Approx. 320 ±10 flashes per minute		
Rotating Cycle		Approx. 130 ±20 rpm (Clockwise rotation)		
Buzzer sound level		80dB ±5dB (at 1M)		

Note: Life of the LED varies according to operating conditions and environment.

General Specifications

Size	86mm diameter
Input Voltage Options	12~24V DC , 24V DC
Functions Available	Continuous , Flashing, Rotating , Buzzer
Operating Humidity	45 to 85% RH (no condensation)
Ambient Temperature	-15°C ~ 40°C (no freezing)
Storage Temperature	-40°C ~ 70°C (no freezing)
Insulation Resistance	100MΩ minimum (500V DC megger)
Vibration Resistance	Operating extremes: 10 to 55Hz, amplitude 0.75mm
Body Color	Black
Material	- Body: ABS resin - Cap lens: PC resin - Fixing bolt: Steel
Mounting Options	- Body direct mount - L-shaped bracket - Installation: Indoor & Outdoor Use
Available Colors	Red / Yellow / Green / Blue / Clear
Protection	RoHS
Rating	IP65
Function control	Lead wire
Wire specifications	22AWG (UL1007)
Weight	170g

Dimensions (Unit:mm)

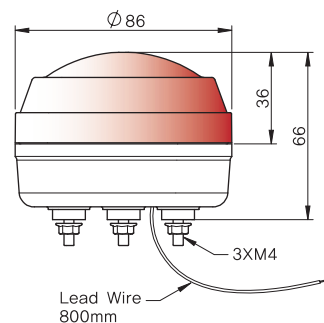

▶ Hole Mounting

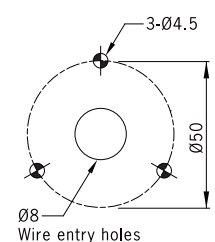

Optional Parts

Wall Mount Brackets See page 34~36 for dimension



MAP-DS30
Plastic



MAM-DS26
Steel

Wiring Diagram

