

## HEAD LED

### GOOD THINGS COME IN SMALL PACKAGES.

The working area is the heart of every machine tool and thus deserves a special spotlight: Waldmann's smallest light ever. Thanks to its compact dimensions, HEAD LED always fits into the tool area and generates a powerful, precise LED spot light thanks to Waldmann's cleverly devised lens.

- Maximum power from an impressively small light
- Ideal for high mechanical stress
- Variants with narrow and wide angles of illumination
- Maintenance-free: LED life of up to 50,000 hours and more
- High system of protection
- Resistance-tested with many cooling agents and lubricants





efficient *light*

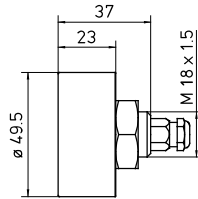

Integrated machine luminaires



Surface-mounted luminaires



**Features at a glance**

- 1 x HIGH POWER LED
- Color temperature daylight white 5,600 K
- Direct illumination or 70° angle of illumination
- Black aluminum anodized housing, 4 mm thick safety glass
- Screw-mounted
- Without switch
- System of protection IP67; class of protection III
- Supplied with 0.15 m mains lead and M12 connection
- Driver to connect to the mains voltage and ready-made M12 plug socket as an accessory

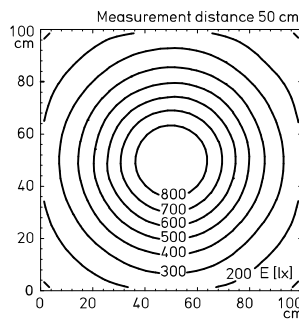

Illuminance based on the example without lens (100°)

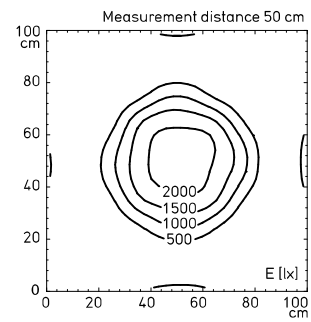

Illuminance based on the example with 70° lens

**CONNECTION TO AC ONSTANT POWER SOURCE WITH 700 MA**

CONSUMPTION	OPERATING DEVICE	DIMENSIONS	SPECIAL FEATURE	$E_m/E_{max}$ *	MODEL	ORDER NO.
11 W	-	ø 49.5 mm	-	398/889 lx <sup>1</sup>	MCAYL 4 S	112 554 000 - 000 031 65
11 W	-	ø 49.5 mm	70° lens	459/2304 lx <sup>1</sup>	MCAYL 4 S	112 554 001 - 000 057 58

\*  $E_m$  = medium illuminance;  $E_{max}$  = maximum illuminance; <sup>1</sup> Measuring range 100 cm x 100 cm/Measuring distance 50 cm

For cooling purposes, the luminaire must be attached to a metal surface.

Detailed data sheet available for download at [www.waldmann-industrial.com](http://www.waldmann-industrial.com)