

# ONE LED

ALWAYS KEEPS ITS COOL.



Less space and high temperatures – in some machines, you are faced with a lot of problems. Where most lights often fail, ONE LED shows its true capabilities: Thanks to its minimalist, but very robust construction, the corresponding design is even resistant to very high temperatures. It is precisely because of this that ONE LED can be compactly integrated in the tool area and illuminates it with high-power LED technology.

- Maximum power from an impressively small light
- Precise positioning of the beam
- Maintenance-free: LED life of up to 50,000 hours and more
- Direct connection to 24 V without additional components
- Safe, fast and easy integration
- Variants for ambient temperatures up to 50° C (variant with safety glass)
- High system of protection
- Safe functionality irrespective of frequent switching or fluctuations of mains voltage
- Resistance-tested with many cooling agents and lubricants (variant with safety glass)



ONE LED with +/- 90° adjustable bracket sheet

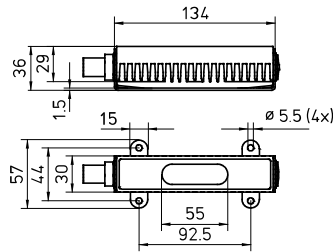

ONE LED for fixed assembly

efficientLight

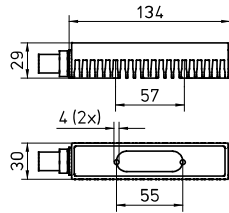

Integrated machine luminaires



Surface-mounted luminaires



Features at a glance

- 1 x HIGH POWER LED
- Color temperature neutral white 5,000 K
- Direct beam
- Aluminum housing, 4 mm thick safety glass or acrylic screen
- Screw-mounted to the housing or +/-90° adjustable bracket sheet
- Without switch
- System of protection IP54 (acrylic screen) or IP67 (safety glass); class of protection III
- Supplied without mains lead, tool-free connection via express connector
- Driver to connect to the mains voltage as an accessory

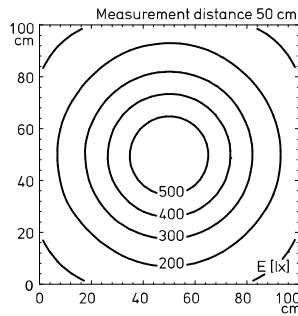

Illuminance 6 W

20 – 28 VDC						cETLus
CONSUMPTION	OPERATING DEVICE	DIMENSIONS	SPECIAL FEATURE	$E_m / E_{max}^*$	MODEL	ORDER NO.
6 W	–	162.5 x 57 mm	PMMA screen, adjustable	261/571 lx <sup>1</sup>	MVAL 1 S	112 887 027 - 000 760 50
6 W	–	162.5 x 57 mm	Glass screen, adjustable	261/571 lx <sup>1</sup>	MVAL 1 S	112 887 037 - 000 760 65
6 W	–	162.5 x 30 mm	PMMA screen	261/571 lx <sup>1</sup>	MVAL 1 S	112 887 024 - 000 760 49
6 W	–	162.5 x 30 mm	Glass screen	261/571 lx <sup>1</sup>	MVAL 1 S	112 887 034 - 000 760 59

\*  $E_m$  = medium illuminance;  $E_{max}$  = maximum illuminance; <sup>1</sup> Measuring range 100 cm x 100 cm/Measuring distance 50 cm