

MULTIBLOC® 00.RST9

Size 00, 160A, 690VAC, Design for bus bar installation, Triple Pole

NH Fuse Switch Disconnecter

The production programme of MULTIBLOC® 00.RST9 comprises NH fuse switch disconnectors for 160A.

Products are designed in triple pole units for direct installation on to 40 mm and 60 mm bus bar systems.

For installation of MULTIBLOC® NH fuse switch disconnectors of different sizes in distribution units with central cover, respective covers are used to obtain a uniform profile in height and length.

MULTIBLOC® size 00 are designed for NH fuse-links in accordance with IEC/EN 60269-2, VDE 0636-2, size 00: 160A.

The system is a modular system, which allows the installation and combination of individual components. MULTIBLOC® offers the user the possibility of fast and easy installation as well as a high degree of security during installation and maintenance.

Features Benefits

- Touch protection IP 30
- Sealing and padlocking device integrated in switch door cover
- Voltage test through holes in slidable windows directly at contacts or tags of NH-fuse links
- Suitable for top/bottom cable terminal connections
- Varieties of cable termination: screw, clamp strap, Al-Cu clamp, frame clamp, extendable for V-terminal - optional
- Varieties for 40 and 60 mm bus bar systems, snap on installation (without drilling) on to 60 mm system without tools possible
- Universally useable for bus bars with thickness of 5 and 10 mm and widths of 12–30 mm
- Installation covering bus bar carrier (max. height 14,5 mm) lateral left or right possible
- Installation depth 95 mm
- Electronic or electro-mechanic fuse monitoring - optional
- Indicating switch for switch door position - optional

Applications

- House incoming units
- Meter distribution units
- Measuring transformer cabinets
- Transmitting stations for telecommunications

Technical data overview

Volt (VAC)	690 VAC
Volt (VDC)	440 VDC
Amper (A)	160 A
Size per Standard	00
Mounting	bus bar installation
SCCR	Ue = AC 400 V; Ie = 160 A 80kA Ue = AC 500 V; Ie = 160 A 80kA Ue = AC 690 V; Ie = 125 A 80kA
Switchability	triple pole switching



Standards

IEC/EN 60 947-3
For NH-fuse links size 000/00 in accordance with IEC/EN 60 269-2, VDE 0636-2



MULTIBLOC® 00.RST9

Size 00, 160A, 690VAC, Design for bus bar installation, Triple Pole

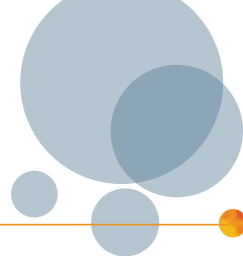

Product range

MULTIBLOC® 00.RST9 size 00 160 A, 690 V AC bus bar installation, triple pole



Catalog number	Reference number	Poles	Bus bar installation	Cable termination components	Design	Weight kg ¹⁾	Package
3.084.000	Z1022993	3	60 mm snap on	3 M8 terminal screws 3 clamp straps 4–70 mm ²	-	0.93	1 piece
3.083.000	X1022991	3	60 mm snap on	3 frame clamps Cu 2,5-70 mm ² factory assembled	-	0.88	1 piece
3.084.300	D1022997	3	60 mm snap on	3 M8 terminal screws 3 clamp straps 4–70 mm ²	fixed window to protect against unauthorized connection	0.88	1 piece
3.083.300	Y1022992	3	60 mm snap on	3 frame clamps Cu 2,5-70 mm ² factory assembled	fixed window to protect against unauthorized connection	0.88	1 piece
3.084.100	B1022995	3	60 mm snap on	3 M8 terminal screws 3 clamp straps 4–70 mm ²	with electronic fuse monitoring ESÜ installed	0.96	1 piece
3.084.200	C1022996	3	60 mm snap on	3 M8 terminal screws 3 clamp straps 4–70 mm ²	with electro-mechanic fuse monitoring MZS installed (galvanic isolation)	1.46	1 piece
2.074.000	W1022990	3	40 mm clamping bar	3 M8 terminal screws 3 clamp straps 4-70 mm ²	-	1.06	1 piece

1) weight in kg per piece or set including package

MULTIBLOC® 00.RST9

Size 00, 160A, 690VAC, Design for bus bar installation, Triple Pole

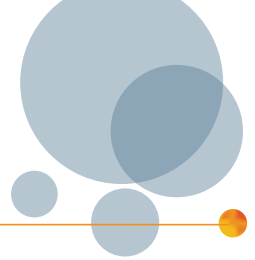

Technical data in accordance with EN / IEC 60947

	00.RST9 triple pole
Installation mode	bus bar installation
Size	00
Number of poles/phases	3
Conventional free air thermal current with NH-fuse links I_{th}	160 A
Max. power dissipation of fuse links P_n	12 W
Conventional free air thermal current with solid links I_{th}	200 A
Max. power dissipation of solid links P_n	1,2 W
Utilization category to IEC/EN 60947-3 $U_e = AC 400 V; I_e = 160 A$ $U_e = AC 500 V; I_e = 160 A$ $U_e = AC 690 V; I_e = 125 A$ $U_e = DC 220 V; I_e = 160 A$ $U_e = DC 440 V; I_e = 100 A$	AC 23 B AC 22 B AC 21 B DC 22 B DC 21 B
Rated operational voltage U_e	690 V
Rated insulation voltage U_i	1000 V
Rated impulse withstand voltage U_{imp}	8 kV
Rated frequency	50 ... 60 Hz
Degree of protection	IP 0
Degree of pollution	3
Rated duty	uninterrupted duty
Rated short circuit making capacity with solid links I_{cm}	6.2 kAsw
Rated short circuit making capacity with fuse links $U_e = AC 400 V; I_e = 160 A$ $U_e = AC 500 V; I_e = 160 A$ $U_e = AC 690 V; I_e = 125 A$	80 kA 80 kA 80 kA
Rated short circuit withstand current I_{cw}	4 kA / 1 s
Power dissipation by I_{th} without NH-fuse links	10 W
Power dissipation by I_{th} without solid links	16 W

Cable terminal connection

Standard cable terminal	M8
for cable lugs Cu max.	2 x 70 mm ²
for cable lugs Al max.	2 x 70 mm ²
for copper bars with max. dimensions	20 x 5 mm

Bus bar terminal connection

Bus bar system	40 mm 60 mm
Bus bar width (bus bar system = 40 mm)	12 mm
Bus bar thickness (bus bar system = 40 mm)	5 ... 10 mm
Bus bar width (bus bar system = 60 mm)	12 ... 30 mm
Bus bar thickness (bus bar system = 60 mm)	5 ... 10 mm

MULTIBLOC® 00.RST9

Size 00, 160A, 690VAC, Design for bus bar installation, Triple Pole

Dimensions

MULTIBLOC® 00.RST9 NH-fuse switch disconnecter triple pole design for bus bar installation (M 01170)

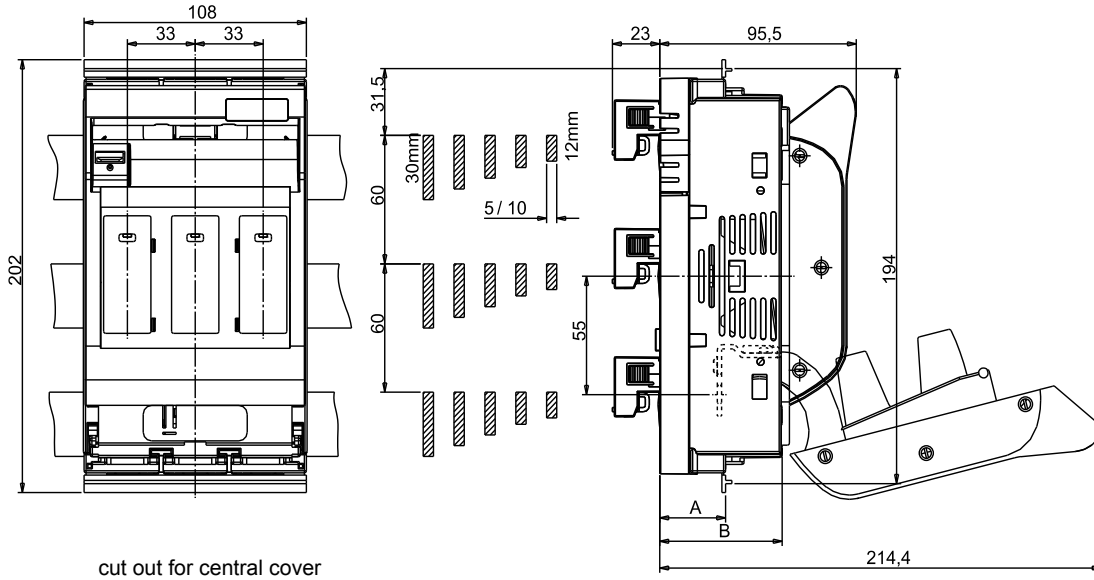

cut out for central cover

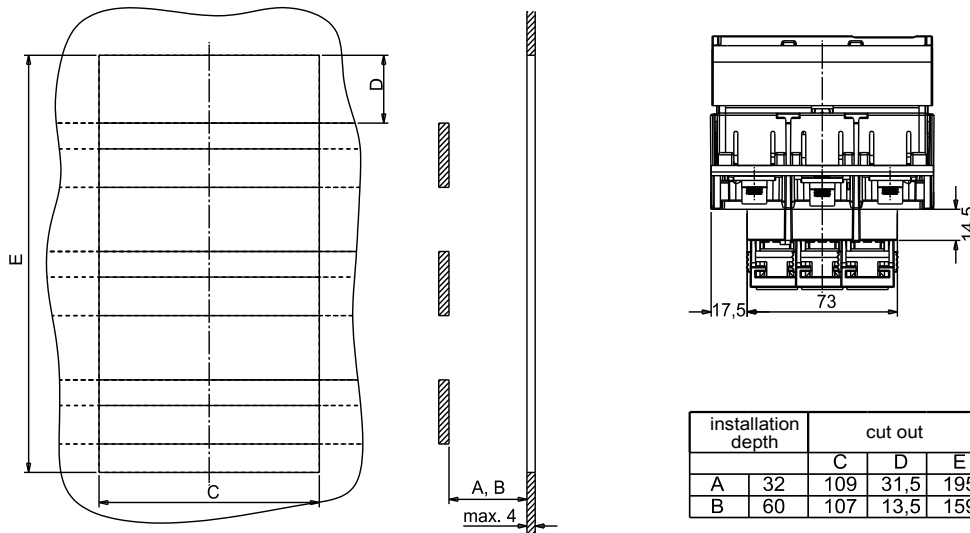

installation depth	cut out			
	C	D	E	
A	32	109	31,5	195
B	60	107	13,5	159

Dimensions in mm

MULTIBLOC® 00.RST9

Size 00, 160A, 690VAC, Design for bus bar installation, Triple Pole

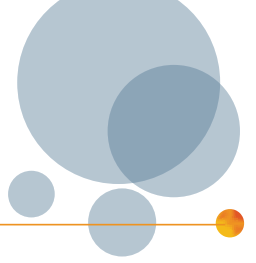

Dimensions

MULTIBLOC® 00.ST9 and 00.RST9 triple pole with electronic fuse monitoring ESÜ (M 01172)

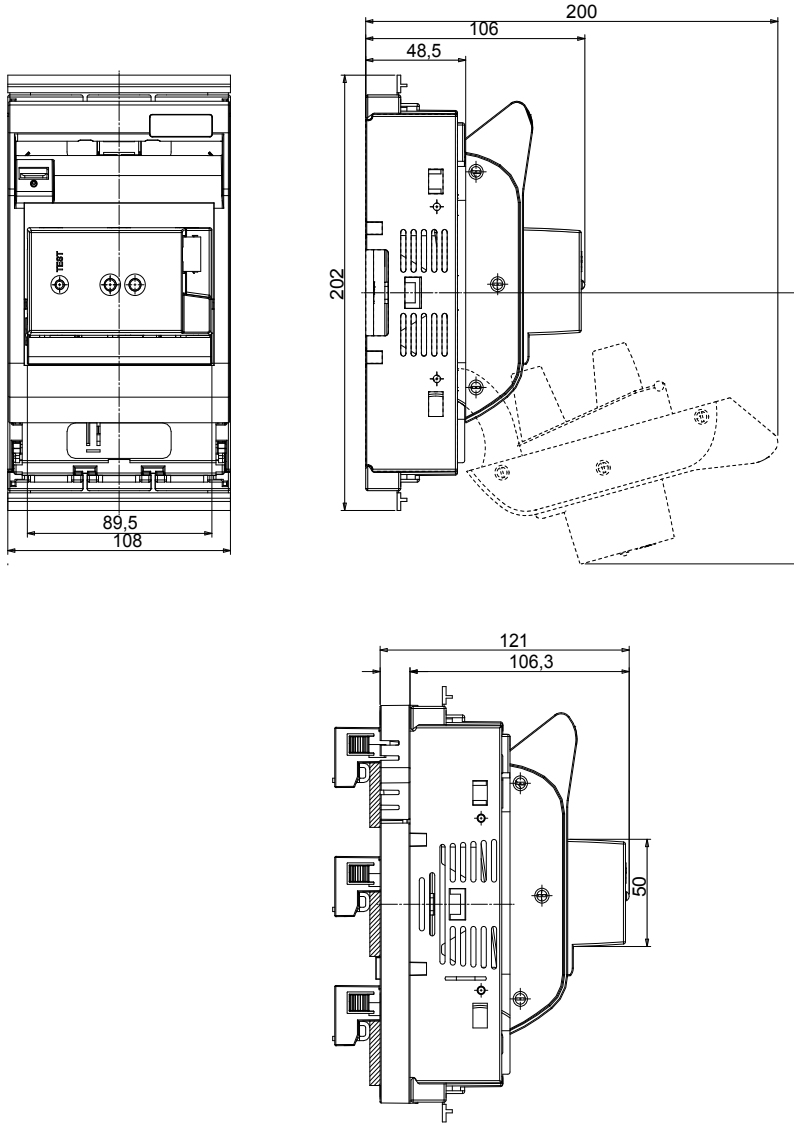

Dimensions in mm

MULTIBLOC® 00.RST9

Size 00, 160A, 690VAC, Design for bus bar installation, Triple Pole

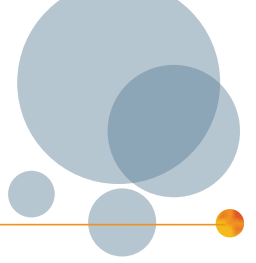

Dimensions

MULTIBLOC® 00.ST9 and 00.RST9 triple pole with electro-mechanic fuse monitoring MZS (M 01135c-00)

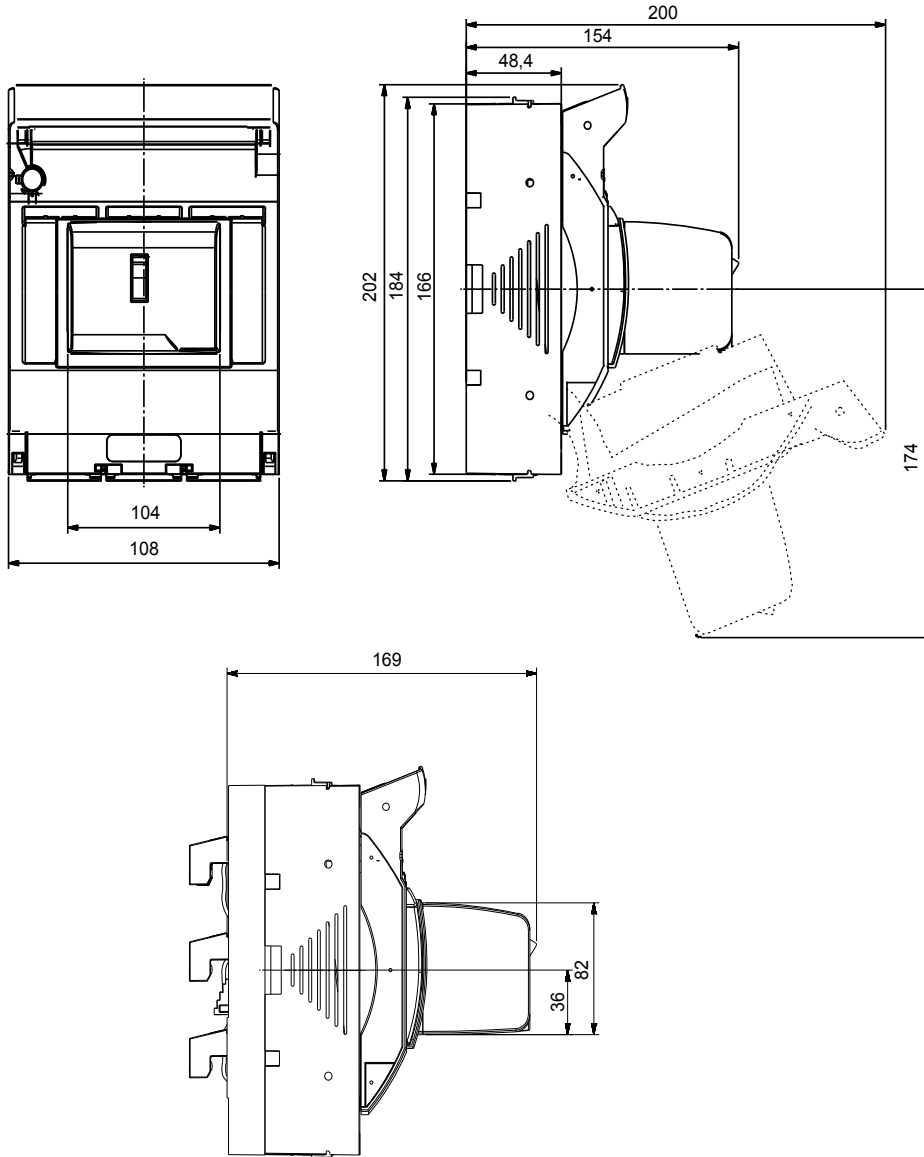

Dimensions in mm

MULTIBLOC® 00.RST9

Size 00, 160A, 690VAC, Design for bus bar installation, Triple Pole

Dimensions

Cable termination size 00 (MA 120c)

type	N	S	A	R
terminal	screw	clamp strap	Al/Cu clamp	frame clamp
	Cu 16-70	Cu 4-70	Cu 1,5-70	Cu 2,5-70
cross section mm ²	Al 16-95	Al ---	Al 1,5-70 sectoral stranded Al 1,5-95 sectoral solid	Al ---
M(an) (Nm)	10	3-4	3-4	6

Dimensions in mm

MULTIBLOC® 00.RST9

Size 00, 160A, 690VAC, Design for bus bar installation, Triple Pole

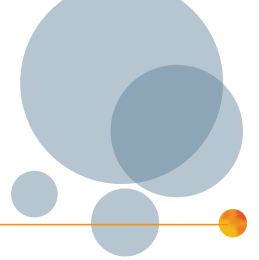

Exploded sketch

MULTIBLOC® 00.RST9 NH- fuse switch disconnecter triple pole design for bus bar installation (E 1.002.785)

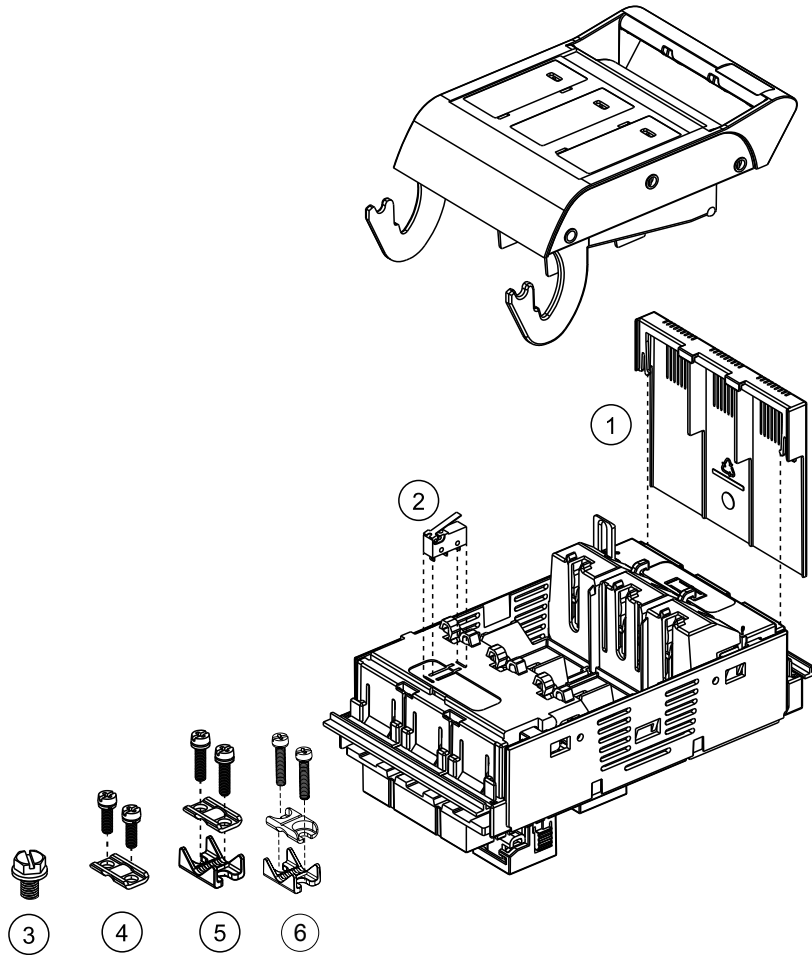

no.	articlenumber	short description
1	1.003.325	bus bar touch protection
2	1.000.852	indicator for switch door position
3	00SZS	M8 terminal screw screw, 1 Set = 3 pieces
4	00SZESK	Clamp strap 4 - 70mm ² , set = 3 pieces
5	00SZA70	Al/Cu clamp 1·5 - 70mm ² , set = 3 pieces
6	1.003.571	Al/Cu clamp 50 - 95 mm ² , set = 3 pieces

MULTIBLOC® 00.RST9

Size 00, 160A, 690VAC, Design for bus bar installation, Triple Pole

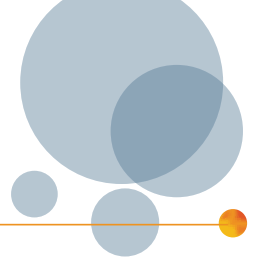

Accessories



1.000.126

1.003.431



1.002.874



1.000.127



1.000.128



1.002.870



1.000.148



1.003.325

Cover shields

Catalog number	Reference number	Design	Weight kg ¹⁾	Package
1.000.126	Y229285	cover shield for installation in distribution units size (width x height): 123 x 190 mm for one 00.ST9/00.RST9	0.02	1 piece
1.003.431	N1022960	cover shield for installation in distribution units size (width x height): 123 x 210 mm for one 00.ST9/00.RST9	-	1 piece
1.002.874	S1022964	cover shield for installation in distribution units size (width x height): 231 x 210 mm for two 00.ST9/00.RST9	0.05	1 piece
1.000.127	Z229286	cover shield for installation in distribution units size (width x height): 231 x 190 mm for two 00.ST9/00.RST9	0.05	1 piece
1.000.128	A229287	cover shield for installation in distribution units size (width x height): 339 x 190 mm for three 00.ST9/00.RST9	0.07	1 piece
1.002.870	R1022963	cover shield for installation in distribution units size (width x height) 231 x 210 mm for one 00.ST9/00.RST9 + lateral spare way cover right side	0.09	1 piece

Cover/shrouds for cable termination

Catalog number	Reference number	Design	Weight kg ¹⁾	Package
1.000.148	W229283	cover for cable terminal connection for 00.ST9 triple pole, 1 set = 2 pieces	0.04	1 set
1.003.325	F1023114	bus bar touch protection for 00.RST9	0.02	1 piece

1) weight in kg per piece or set including package

MULTIBLOC® 00.RST9

Size 00, 160A, 690VAC, Design for bus bar installation, Triple Pole

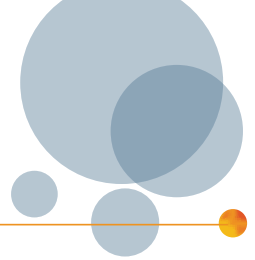

Accessories



1.000.852

1.000.157

Indication facilities

Catalog number	Reference number	Design	Weight kg ¹⁾	Package
1.000.852	Q1002285	indicator for switch door position micro switch, 1 change-over contact 5 A, 250 V	0.00	1 piece
1.000.157	S1022987	indicator for switch door position micro switch 1 "a" contact/ 1 "b" contact, 5 A, 250 V for MULTIBLOC® 00.RST9 for 40 mm bus bar system	0.01	1 piece

Varieties of cable termination



00SZS

00SZESK

00SZA70

1.003.571

1.003.433

00SZSV6

Catalog number	Reference number	Design	Weight kg ¹⁾	Package
00SZS	M229298	M8 terminal screw for switch gear size 00 1 set = 3 pieces	0.03	1 set
00SZESK	E214594	clamp strap Cu 4–70 mm ² for switch gear size 00 1 set = 3 pieces	0.04	1 set
00SZA70	R211523	Al/Cu clamp 1,5–70 mm ² for switch gear size 00 1 set = 3 pieces	0.08	1 set
1.003.571	V1033684	Al/Cu clamp 50–95 mm ² round stranded for switch gear size 00 1 set = 3 pieces	0.10	1 set
1.003.433	L1022958	triple clamp per pole 1.5 up to 16 mm ² 1 set = 3 pieces	-	1 piece
00SZSV6	K1022957	V-shaped lug size 00, M8, for V-terminal clamp size 00 for switch gear size 00 with screw terminal supplementary set for V-terminal with V-terminal clamps 1 set = 3 pieces	0.13	1 set

1) weight in kg per piece or set including package