

# MS86L Series D86mm LED Steady / Flashing Signal Lights



MS86L series LED Dome Indicator Light The dome shape provides increased visibility and the LEDs provide years of maintenance-free operation.



## ◀ Dome head type

- Ultra bright LED
- Wide light distribution with prism-cut dome-shaped lens
- Outstanding visibility at distance
- Selectable Steady or Flashing Modes for LED lights
- Red, Yellow, Green, Blue and lens available
- IP65 rated

## ▼ Low head type



## Ordering Information

**MS86L - F 0 2 - R - F**

①      ②      ③      ④

### 1. Light Style

<b>F</b>	LED Steady + Flashing
<b>B</b>	LED Steady + Flashing + Buzzer

### 2. Power Supply

<b>02</b>	24V AC/DC
<b>FF</b>	90~240V AC

### 3. Lens Colors

<b>R</b>	Red
<b>Y</b>	Yellow
<b>G</b>	Green
<b>B</b>	Blue
<b>C</b>	Clear

### 4. Lens cap Style

	Dome type lens cap
<b>F</b>	Low head type lens cap



## Specifications

Operation/Function	Steady , Flashing , Buzzer
Power Supply	AC/DC 24V , AC 90 ~ 240V (50/60 Hz)
Buzzer Sound Level	Approx. 80±5 dB (at 1M)
Lens Color	Red, Yellow, Green, Blue & Clear
Lens Diameter	86 mm
Flash Rate	80 times/ minute
Vibration	0.75mm at 10~55Hz
Ambient Temperature	-20°C~40°C
Storage Temperature	-40°C ~ 70°C
Ambient Humidity	45~85% RH
Degree of Protection	IP65 / IP52 (with Buzzer)
Approvals	UL, RoHS
Recommended Wire Size	PUR Ø5 / PVC Ø1.25 2P 0.3SQ, 300mm
Weight	Approx.150g

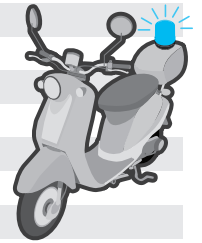

## Current consumption (Maximum current consumption when LED is lit.)

Power Spec	24V DC	90~240V AC	Buzzer
Red LED	120mA	30~50mA	30mA
Yellow LED	120mA		
Green LED	140mA	30~50mA	30mA
Blue LED			
White LED			

\* Outside dimension and performance of the product are subject to change without notice to improve the product.

## Dimensions (unit: mm)

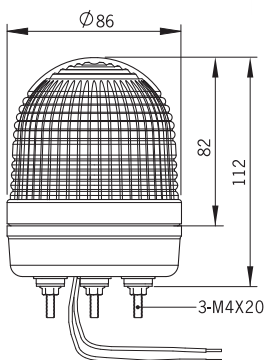

Power supply wire From wire exit 300mm

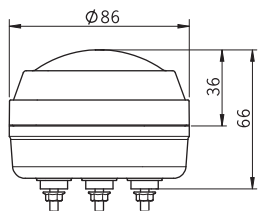

## Lights or Flashing Conversion dip Switch

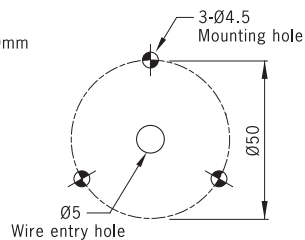
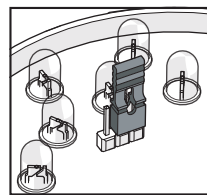

## ▲ Stud Mount hole layout

## Wiring Diagram

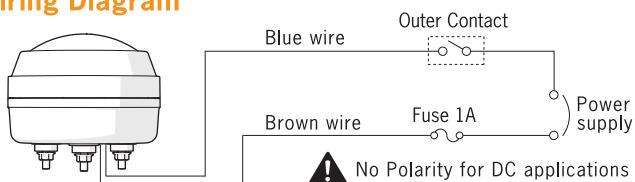

## Optional Orders

### 1. Pole mount adaptor

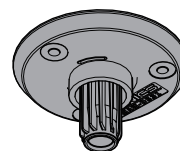

**MAM-DS31**  
ABS resin

### 2. Wall Mount Brackets



**MAP-DS30**  
ABS resin

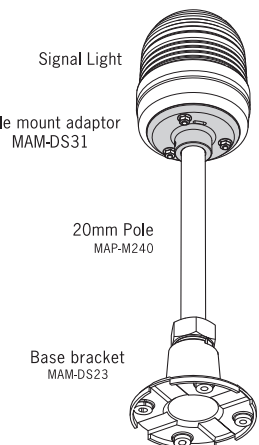

Base bracket  
**MAM-DS23**

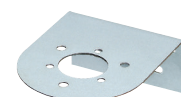

**MAM-DS26**  
Steel

See Page 34 ~ 36  
for Mounting Options and Accessories.

