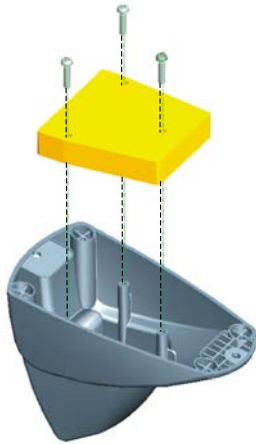

METAL PLATE FOR STD-Heron™**Installation Instructions****Figure 1**

GENERAL FEATURES AND INSTALLATION

The Metal Plate for STD- Heron™ can be installed inside the stand base to make it suitable for desktop use. In this way, the reader can be safely paired to STD-Heron™ even when the stand is not fixed to the surface.

The Metal Plate is supplied with 3 screws.

Insert the Metal Plate inside the stand base and fix it by means of the 3 screws as shown in Figure 1.

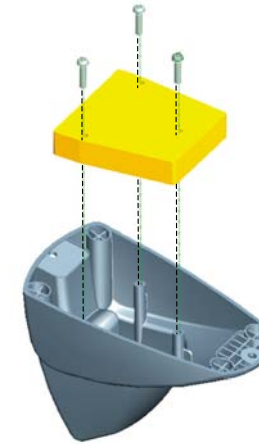
METAL PLATE FOR STD-Heron™**Installation Instructions****Figure 1**

GENERAL FEATURES AND INSTALLATION

The Metal Plate for STD- Heron™ can be installed inside the stand base to make it suitable for desktop use. In this way, the reader can be safely paired to STD-Heron™ even when the stand is not fixed to the surface.

The Metal Plate is supplied with 3 screws.

Insert the Metal Plate inside the stand base and fix it by means of the 3 screws as shown in Figure 1.