

ABL

THE FLEXIBLE HEAD FOR TOUGH TASKS.



With its minimalist design, the ABL is as small and handy as a mini flashlight that can be fixed in any position. The fact that it is extremely tough in spite of its delicate appearance makes it a highly versatile luminaire.

- Fast and precise positioning
- High luminous power with low energy consumption
- Variants with narrow and wide angles of illumination
- Insensitive to vibrations, resistant to metal chippings
- Maintenance-free: LED life of up to 50,000 hours and more



efficientLight

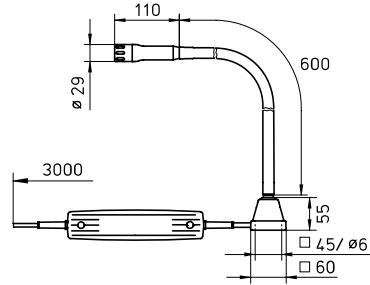

Tip: Drawing shows luminaire with separate transformer

Features at a glance

- 1 x HIGH POWER LED
- Color temperature daylight white 6,000 K
- 6° or 25° angle of illumination
- Black aluminum anodized housing, 2 mm thick safety glass
- Metal flexible tube for at least 20,000 movements
- Without switch
- System of protection IP67 (without transformer) or IP20 (with transformer, luminaire head IP67); class of protection III (without transformer) or II (with transformer)
- Supplied with 3 m mains lead with free stranded wires or integrated power pack with plug type CEE 7/16 (Euro plug)
- Various fastenings and drivers as accessories

Integrated machine luminaires



Surface-mounted luminaires



Tube luminaires



Arm-mounted luminaires

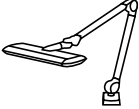

Flexible-tube luminaires

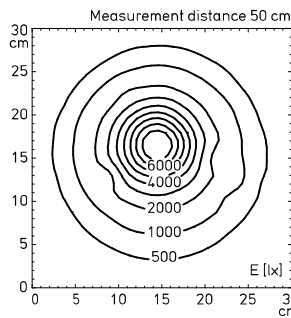
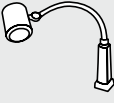

Illuminance with 6° lens

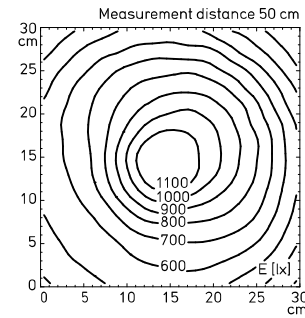

Illuminance with 25° lens

CONNECTION TO A CONSTANT POWER SOURCE WITH 350 OR 700 MA

CONSUMPTION	OPERATING DEVICE	CONNECTED LOAD	SPECIAL FEATURE	E_m/E_{max}^*	MODEL	ORDER NO.
3 W	-	Dependent on the driver	6° lens	1219/8966 lx ¹	ABLTL 1	112 423 000 - 000 715 50
3 W	-	Dependent on the driver	25° lens	691/1260 lx ¹	ABLTL 1	112 423 001 - 000 715 49

CONSUMPTION	OPERATING DEVICE	CONNECTED LOAD	SPECIAL FEATURE	E_m/E_{max}^*	MODEL	ORDER NO.
3 W	Transformer in separate housing	95 – 240 V, 50/60 Hz	6° lens	1219/8966 lx ¹	ABLTL 1	112 426 000 - 000 740 02
3 W	Transformer in separate housing	95 – 240 V, 50/60 Hz	25° lens	691/1260 lx ¹	ABLTL 1	112 426 001 - 000 741 55

* E_m = medium illuminance; E_{max} = maximum illuminance; ¹ Measuring range 30 cm x 30 cm/Measuring distance 50 cm
 Also available as a pivoting-head luminaire